



## Werbeflächen für Sponsoren und Aussteller des DGGG 2018

## Advertising Spaces at the CityCube Berlin Indoors and Outdoors

---



# CityCube Berlin

## Site Map

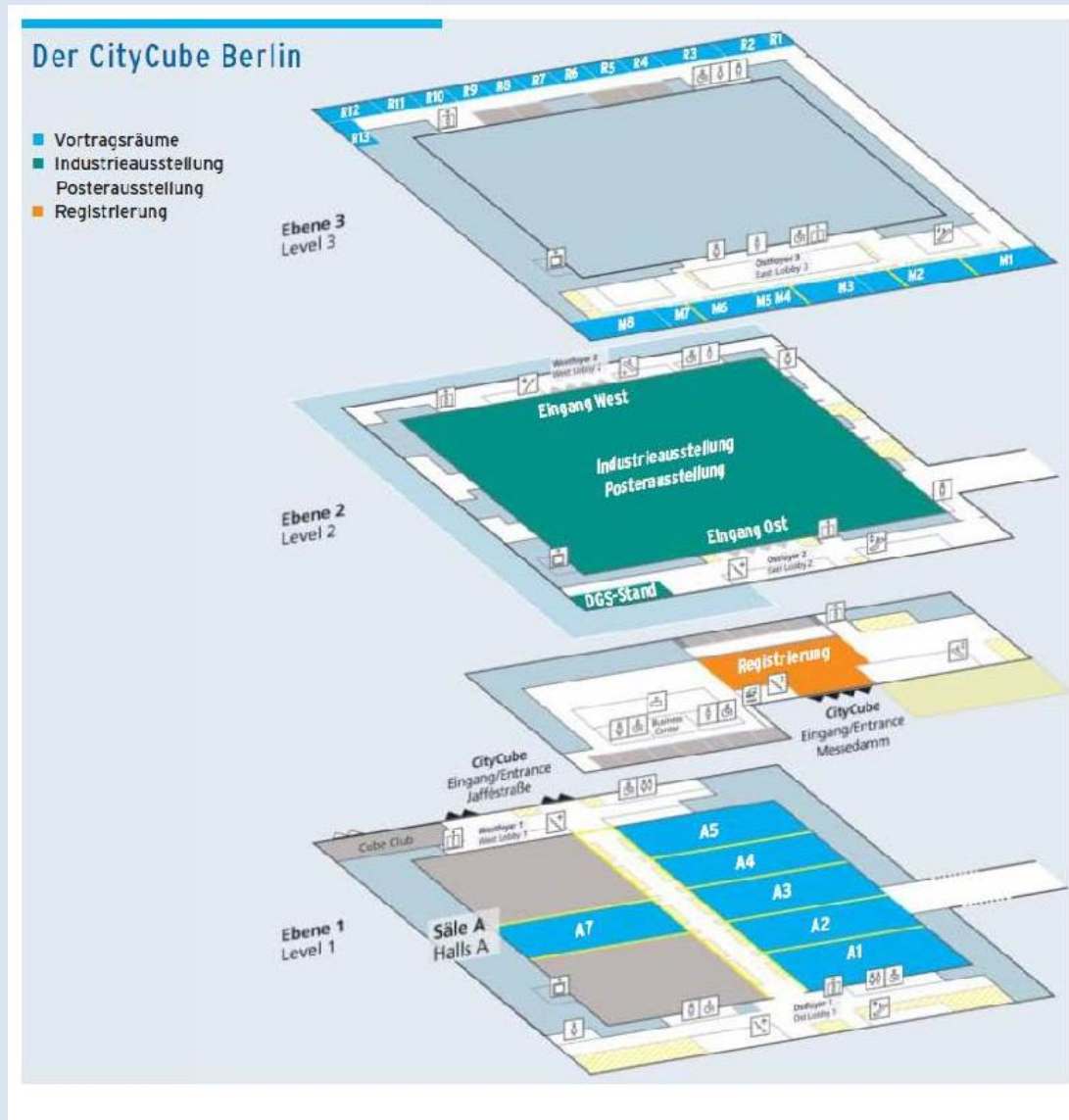



# CityCube Berlin Entrance Messedamm: Outdoors

## Advertising Towers at the Access, each 4-sided

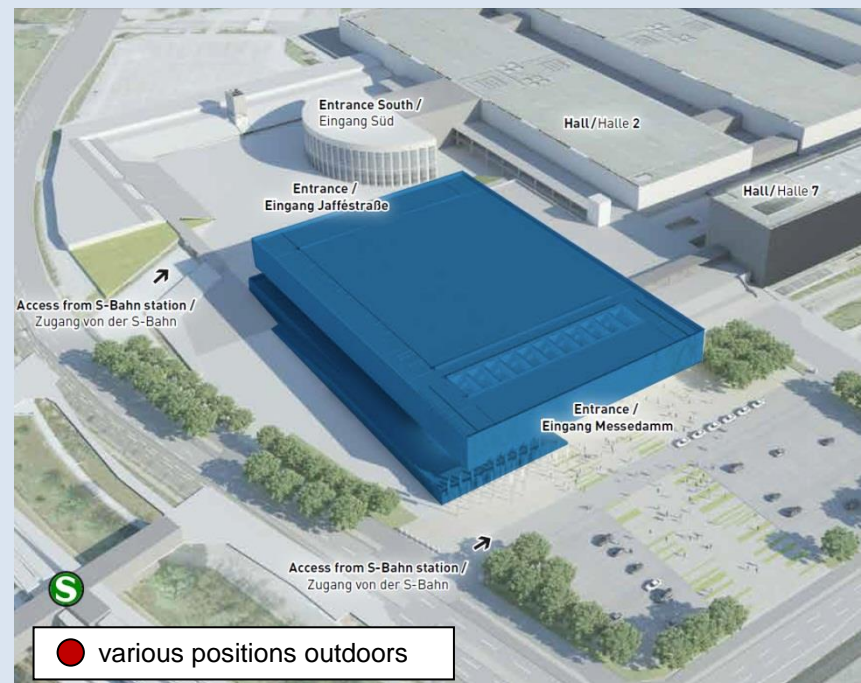

Availability on request

Location/ Short Description	Measurements in m (w x h)	Hire Charge	Production and Installation
❖ at diverse locations in front of the CityCube Berlin at the access to the Entrance Messedamm	e.g. 2.18 x 3.90 per side e.g. 3.18 x 5.90 per side (4 sides per tower – other formats are possible)	3.500 Euro 7.300 Euro in each case per tower	2.455 Euro 4.245 Euro in each case per tower

All indicated prices plus Value Added Tax. Subject to change. Subject to confirmation. The indicated prices apply to the period of exhibition.  
Agency commissions will not be accorded. Prices do not include graphic design/ layout of the advertising material.

## CityCube Berlin Entrance Messedamm Indoor Advertising

---





# CityCube Berlin Entrance Messedamm: Indoors

## Handrail Graphics at Escalators

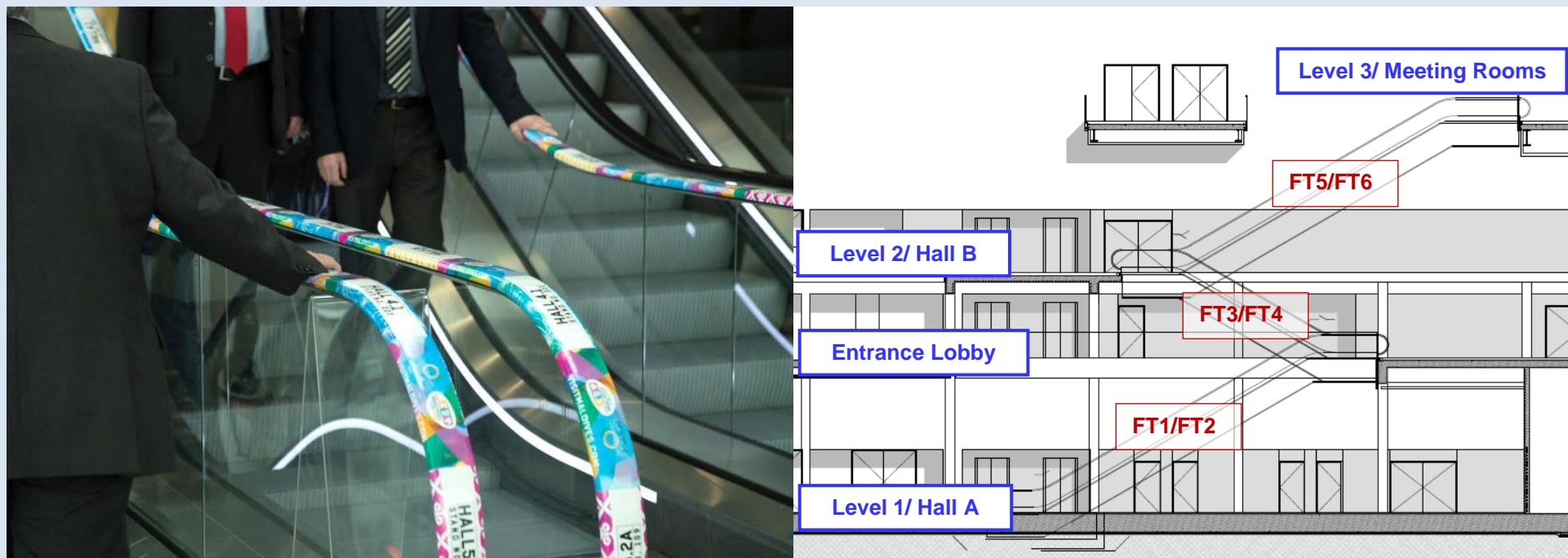

Availability on request

Location/Short Description	Measurements	Hire Charge	Production and Installation
❖ escalators between the entrance lobby and levels 1, 2 and 3 (see map on the right)	2 escalators FT1/FT2: length 40.00 m each	3.700 Euro	3.088 Euro
	2 escalators FT3/FT4: length 29.00 m each	2.800 Euro	2.525 Euro
	2 escalators FT5/FT6: length 42.00 m each	4.200 Euro	3.180 Euro
	width: 152.00 mm each, thereof 60.00 mm centre area	per escalator, i.e. for 2 handrails	per escalator, i.e. for 2 handrails

All indicated prices plus Value Added Tax. Subject to change. Subject to confirmation. The indicated prices apply to the period of exhibition. Agency commissions will not be accorded. Prices do not include graphic design/ layout of the advertising material.

## CityCube Berlin Entrance Messedamm: Indoors

### Balustrade Brandings at Escalators

---





# CityCube Berlin Entrance Messedamm: Indoors

## Balustrade Brandings at Escalators

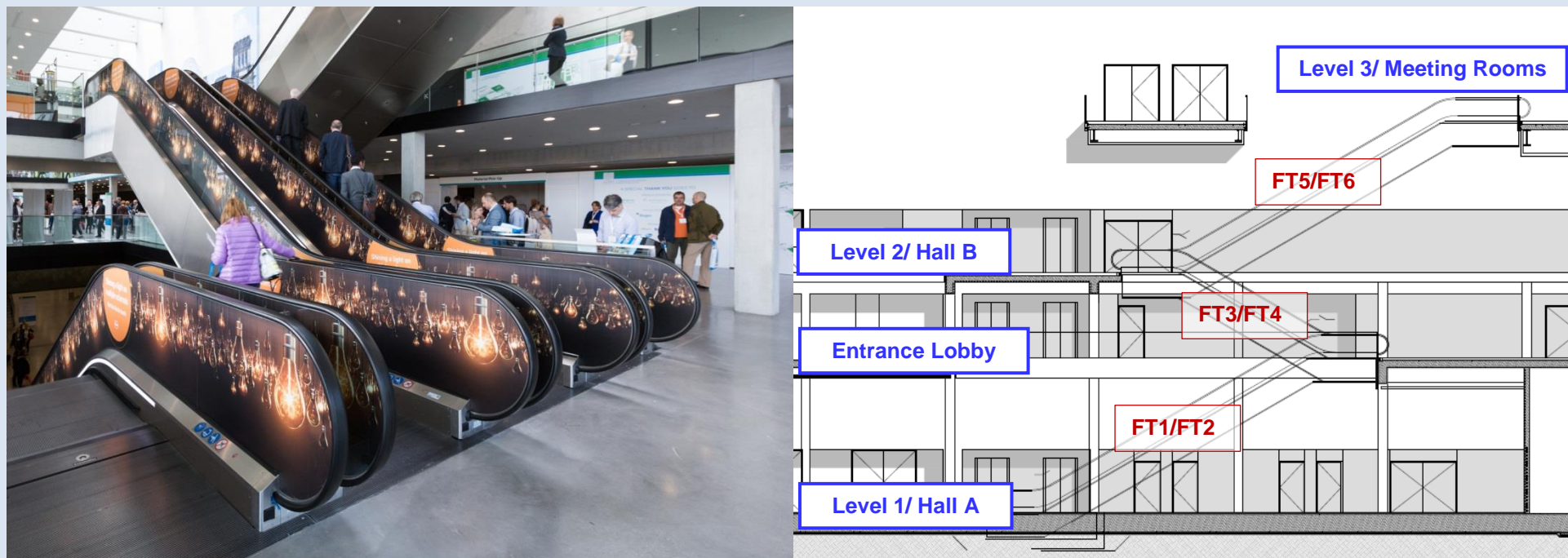

Availability on request

Location/Short Description	Measurements	Hire Charge	Production and Installation
❖ escalators in the entrance lobby leading to levels 1, 2 and 3 (see detailed map on the right)	2 escalators FT1/FT2: approx. 32.00 m <sup>2</sup>	7.400 Euro	2.592 Euro
	2 escalators FT3/FT4: approx. 21.20 m <sup>2</sup>	5.100 Euro	1.755 Euro
	2 escalators FT5/FT6: approx. 30.20 m <sup>2</sup>	6.900 Euro	2.456 Euro
	in each case per escalator, i.e. for 2 balustrades	per escalator, i.e. for 2 balustrades	per escalator, i.e. for 2 balustrades

All indicated prices plus Value Added Tax. Subject to change. Subject to confirmation. The indicated prices apply to the period of exhibition. Agency commissions will not be accorded. Prices do not include graphic design/ layout of the advertising material.



# CityCube Berlin Entrance Messedamm: Indoors

## Stair Graphics Entrance Lobby/ Lobby 2

---



# CityCube Berlin Entrance Messedamm: Indoors

## Stair Graphics Entrance Lobby/ Lobby 2: Small Version

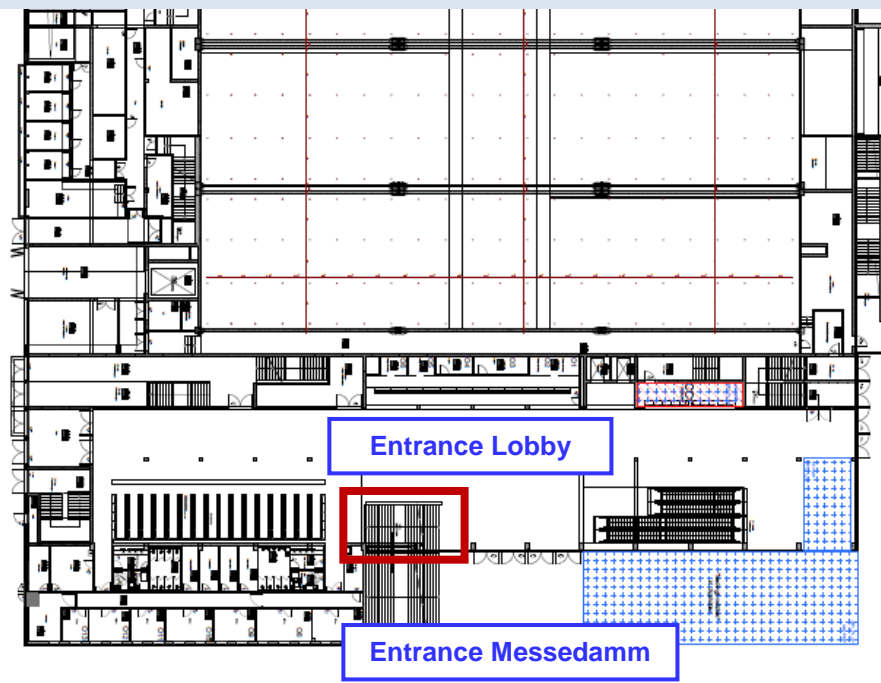
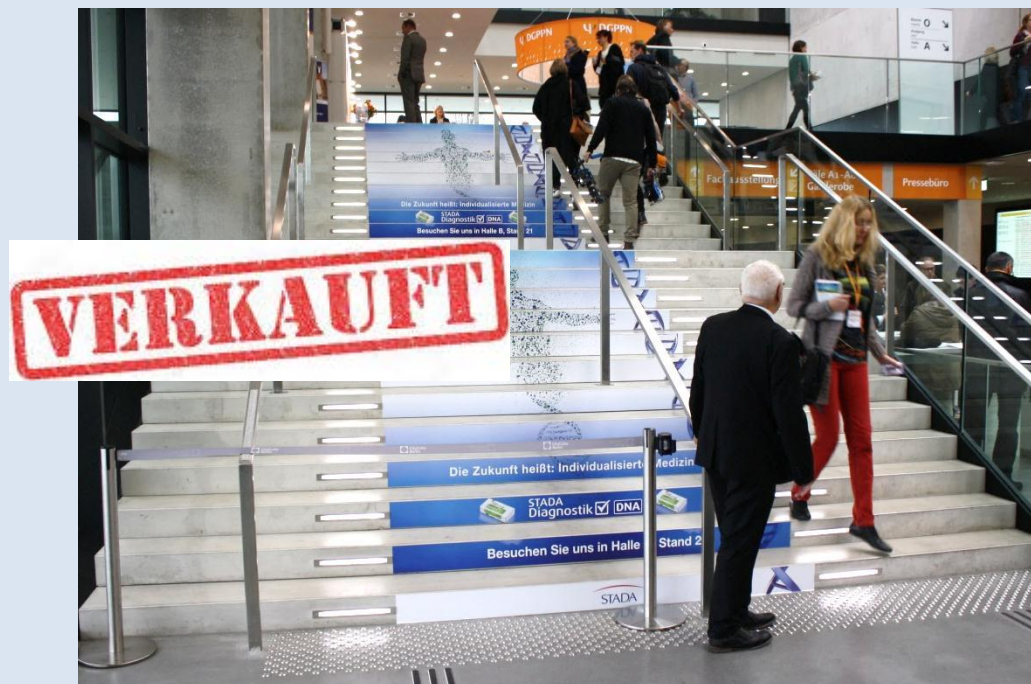

Availability on request

Location/Short Description	Measurements in m (w x h)	Hire Charge	Production and Installation
❖ staircase between the entrance lobby and level 2 (see red mark on the right map): every step can be equipped with an adhesive foil on the central area (see left photo)	<b>"partial branding of every step"</b> central part of every step. 2.18 x 0.145 (23 steps in total)	4.700 Euro for all 23 stair graphics	598 Euro for all 23 stair graphics

All indicated prices plus Value Added Tax. Subject to change. Subject to confirmation. The indicated prices apply to the period of exhibition. Agency commissions will not be accorded. Prices do not include graphic design/ layout of the advertising material.



# CityCube Berlin Entrance Messedamm: Indoors

## Stair Graphics Entrance Lobby/ Lobby 2: Full Version

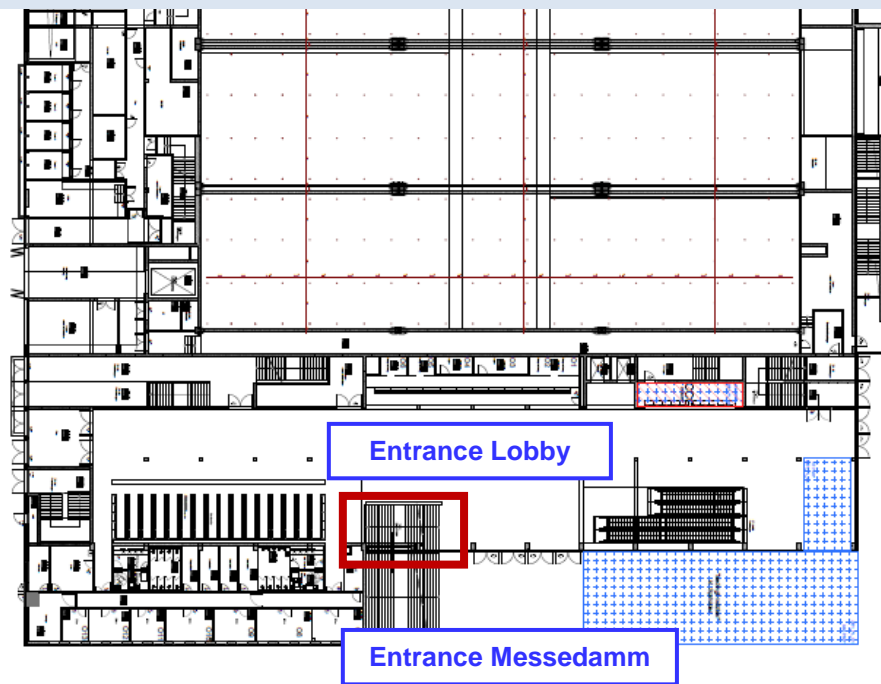
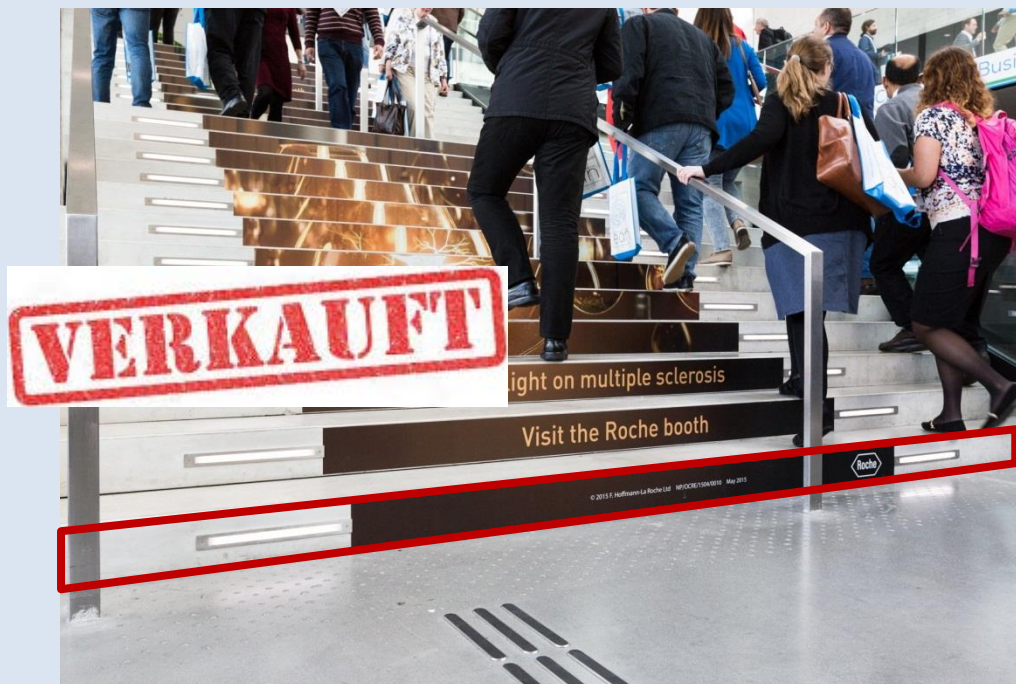

Availability on request

	Measurements in m (w x h)	Hire Charge	Production and Installation
❖ staircase between the entrance lobby and level 2 (see red mark on the right map): every step can be equipped with an adhesive foil on the full area (lamps excluded): see red mark on the left photo	<b>"full branding of every step"</b> steps 1-7 and 10-22: 5.15 x 0.15 each steps 8, 9 and 23: 4.37 x 0.15 each (23 steps in total)	6.100 Euro for all 23 stair graphics	902 Euro for all 23 stair graphics

All indicated prices plus Value Added Tax. Subject to change. Subject to confirmation. The indicated prices apply to the period of exhibition. Agency commissions will not be accorded. Prices do not include graphic design/ layout of the advertising material.



# CityCube Berlin East Lobby 1/ Hall A

## Indoor Advertising

---



# CityCube Berlin East Lobby 1/ Hall A: Indoors

## Stair Graphics Lobby 1/ Entrance Lobby: Small Version

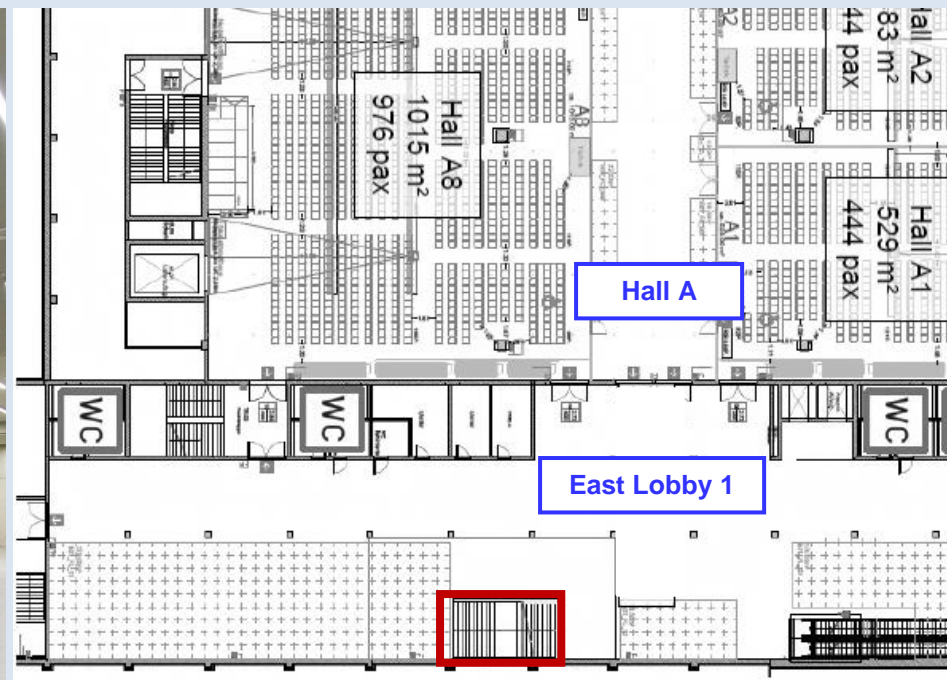
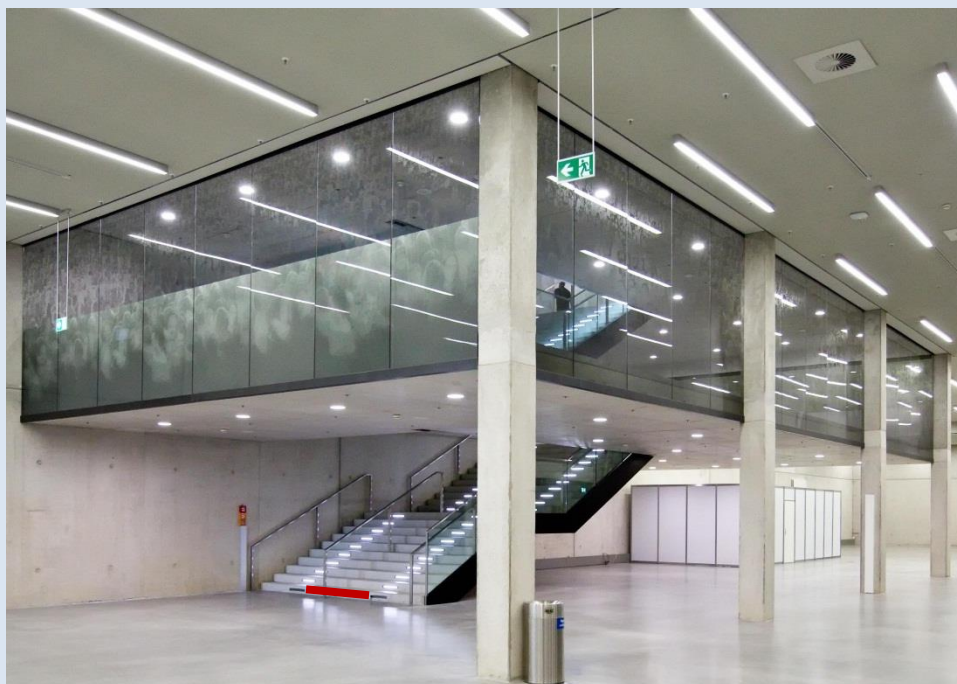

Availability on request

Location/Short Description	Measurements in m (w x h)	Hire Charge	Production and Installation
❖ staircase leading from level 1 to the entrance lobby (see red mark on the right map): every step can be equipped with an adhesive foil on the central area (see red mark on the left photo)	<b>“partial branding of every step”</b> central part: 1.80 x 0.145 each (42 steps in total)	3.900 Euro for all 42 stair graphics	1.092 Euro for all 42 stair graphics

All indicated prices plus Value Added Tax. Subject to change. Subject to confirmation. The indicated prices apply to the period of exhibition. Agency commissions will not be accorded. Prices do not include graphic design/ layout of the advertising material.



# CityCube Berlin East Lobby 1/ Hall A: Indoors

## Stair Graphics Lobby 1/ Entrance Lobby: Full Version

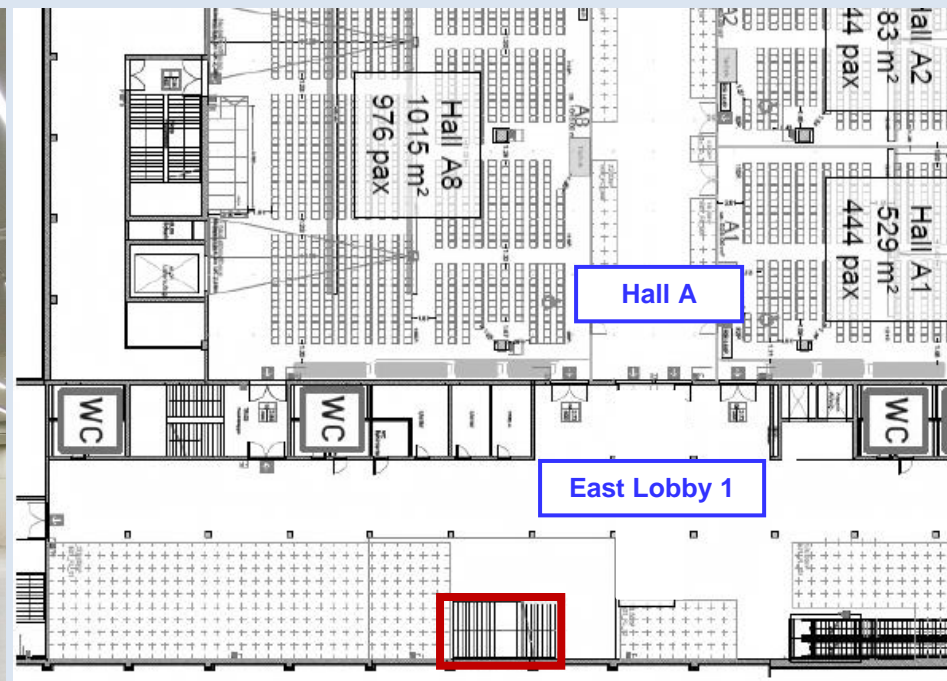
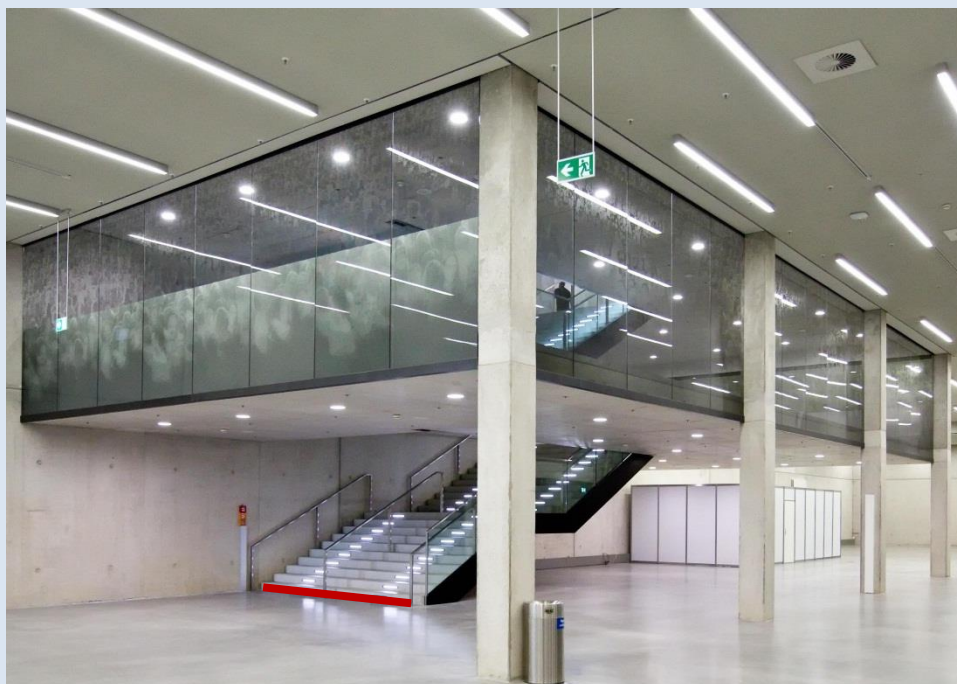

Availability on request

Location/Short Description	Measurements in m (w x h)	Hire Charge	Production and Installation
❖ staircase leading from level 1 to the entrance lobby (see red mark on the right map): every step can be equipped with an adhesive foil on the full area (lamps excluded): see red mark on the left photo	<b>“full branding of every step”</b> 4.37 x 0.15 per step (42 steps in total)	5.500 Euro for all 42 stair graphics	1.428 Euro for all 42 stair graphics

All indicated prices plus Value Added Tax. Subject to change. Subject to confirmation. The indicated prices apply to the period of exhibition. Agency commissions will not be accorded. Prices do not include graphic design/ layout of the advertising material.



# CityCube Berlin East Lobby 1/ Hall A: Indoors

## 2 Entrance Banners Hall A

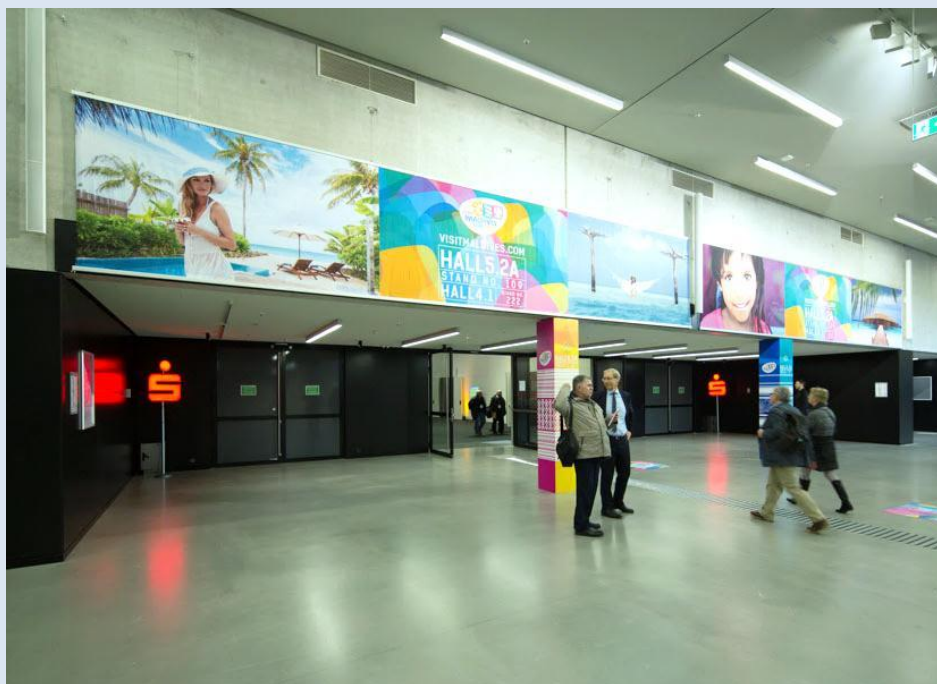

Availability on request

Location/Short Description	Measurements in m (w x h)	Hire Charge	Production and Installation
❖ directly above the entrance doors to hall A on level 1 coming from the east lobby: see red mark on the right map	approx. 9.00 x 1.65 per banner	5.500 Euro for both banners	2.180 Euro for both banners

All indicated prices plus Value Added Tax. Subject to change. Subject to confirmation. The indicated prices apply to the period of exhibition. Agency commissions will not be accorded. Prices do not include graphic design/ layout of the advertising material.

## CityCube Berlin East Lobby 2/ Hall B Indoor Advertising



# CityCube Berlin East Lobby 2/ Hall B: Indoors

## 3 Balustrade Brandings

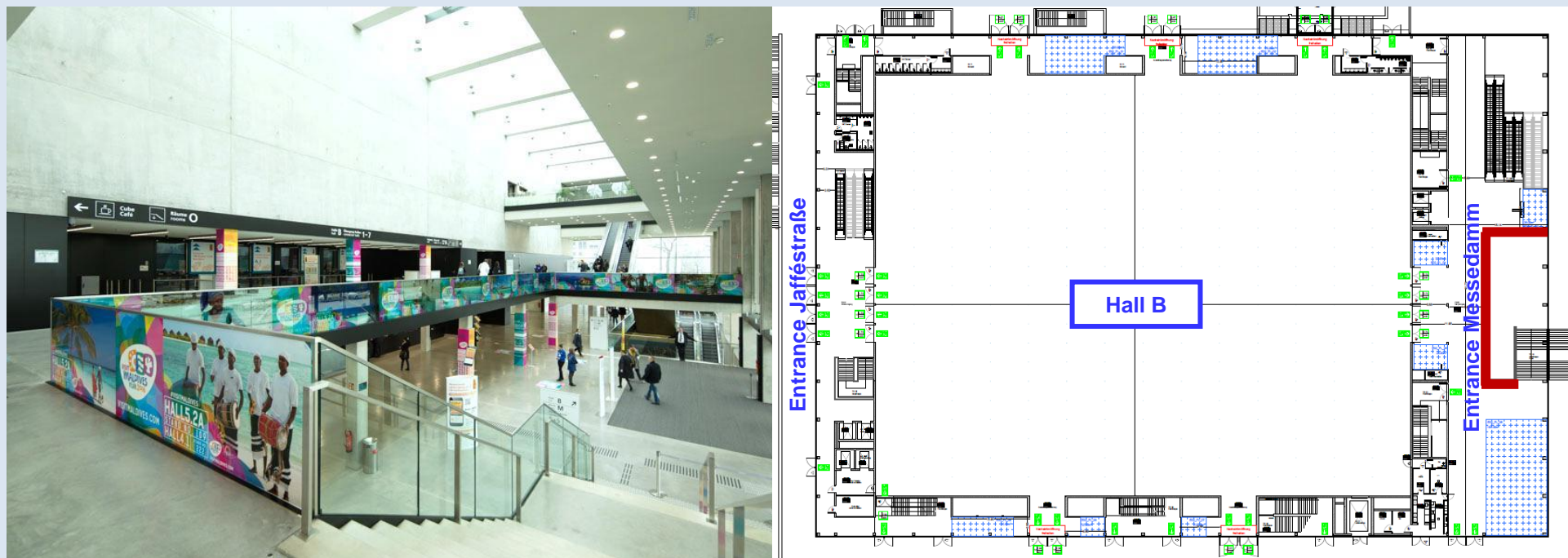

Availability on request

Location/Short Description	Measurements in m (w x h)	Hire Charge	Production and Installation
❖ foil brandings on the glass balustrades in the east lobby 2 in front of hall B: see red marks on the left picture and on the right map	approx. 25.00 x 1.00 double-sided approx. 10.00 x 1.00 double-sided approx. 5.00 x 1.00 double-sided	6.100 Euro 3.300 Euro 2.100 Euro	1.680 Euro 720 Euro 360 Euro

All indicated prices plus Value Added Tax. Subject to change. Subject to confirmation. The indicated prices apply to the period of exhibition. Agency commissions will not be accorded. Prices do not include graphic design/ layout of the advertising material.



## CityCube Berlin East Lobby 2/ Hall B: Indoors

### 1 Entrance Banner Hall B

---



# CityCube Berlin East Lobby 2/ Hall B: Indoors

## 1 Entrance Banner Hall B



Availability on request

Location/Short Description	Measurements in m (w x h)	Hire Charge	Production and Installation
❖ directly above the entrance doors to hall B on level 2 coming from the east lobby: see red mark on the right map	e.g. 29.00 x 2.40 Other formats on demand.	7.900 Euro on demand	3.130 Euro on demand

All indicated prices plus Value Added Tax. Subject to change. Subject to confirmation. The indicated prices apply to the period of exhibition. Agency commissions will not be accorded. Prices do not include graphic design/ layout of the advertising material.

## CityCube Berlin East Lobbies 2 and 3 Indoor Advertising

---





# CityCube Berlin East Lobbies 2 and 3: Indoors

## Hanging Banners

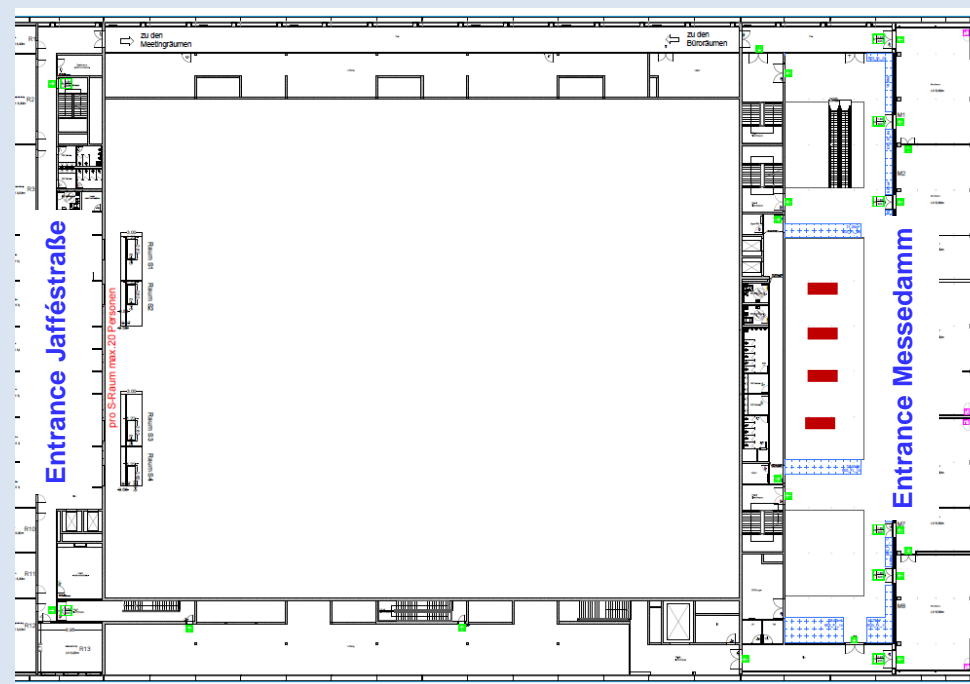
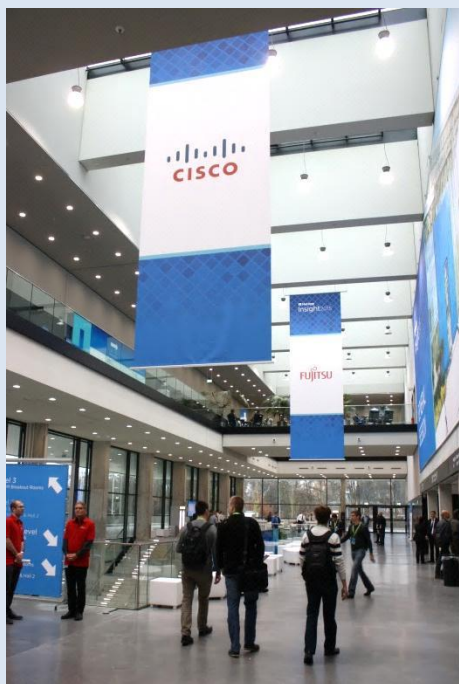

Availability on request

Location/Short Description	Measurements in m (w x h)	Hire Charge	Production and Installation
❖ various suspended banners at diverse locations between levels 2 and 3 in the east lobbies: see red exemplary marks on the right map	e.g. 3.00 x 6.00 per double-sided banner Other sizes and special formats on demand.	4.700 Euro per double-sided banner	1.995 Euro per double-sided banner

All indicated prices plus Value Added Tax. Subject to change. Subject to confirmation. The indicated prices apply to the period of exhibition.  
Agency commissions will not be accorded. Prices do not include graphic design/ layout of the advertising material.

# CityCube Berlin East Lobby 3: Indoors

## 3 Balustrade Brandings

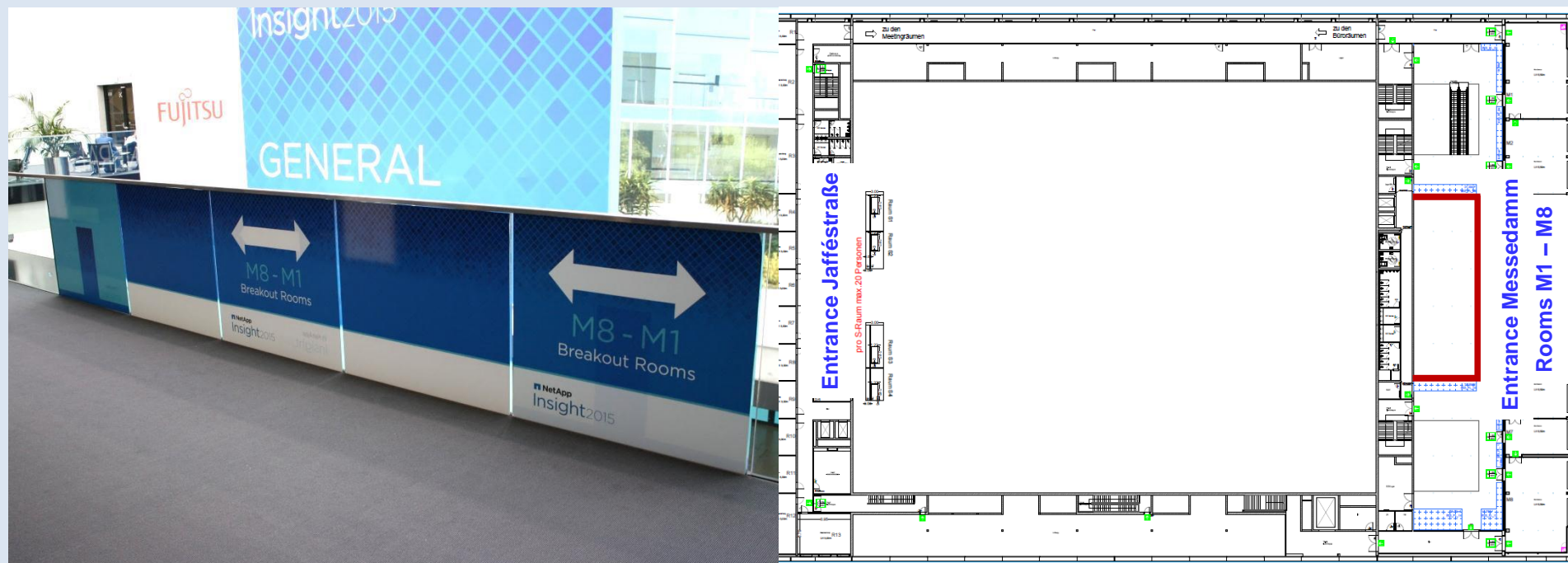

Availability on request

Location/Short Description	Measurements in m (w x h)	Hire Charge	Production and Installation
❖ foil brandings on the glass balustrades in the east lobby 3 in front of the meeting rooms M1 – M8: see red marks on the right map	approx. 28.00 x 1.00 middle	6.900 Euro	2.020 Euro
	approx. 11.00 x 1.00 side	3.900 Euro	795 Euro
	approx. 11.00 x 1.00 side	3.900 Euro	795 Euro

All indicated prices plus Value Added Tax. Subject to change. Subject to confirmation. The indicated prices apply to the period of exhibition. Agency commissions will not be accorded. Prices do not include graphic design/ layout of the advertising material.



# CityCube Berlin East Lobby 3: Indoors

## Branding Balustrades of 2 Lateral Parts

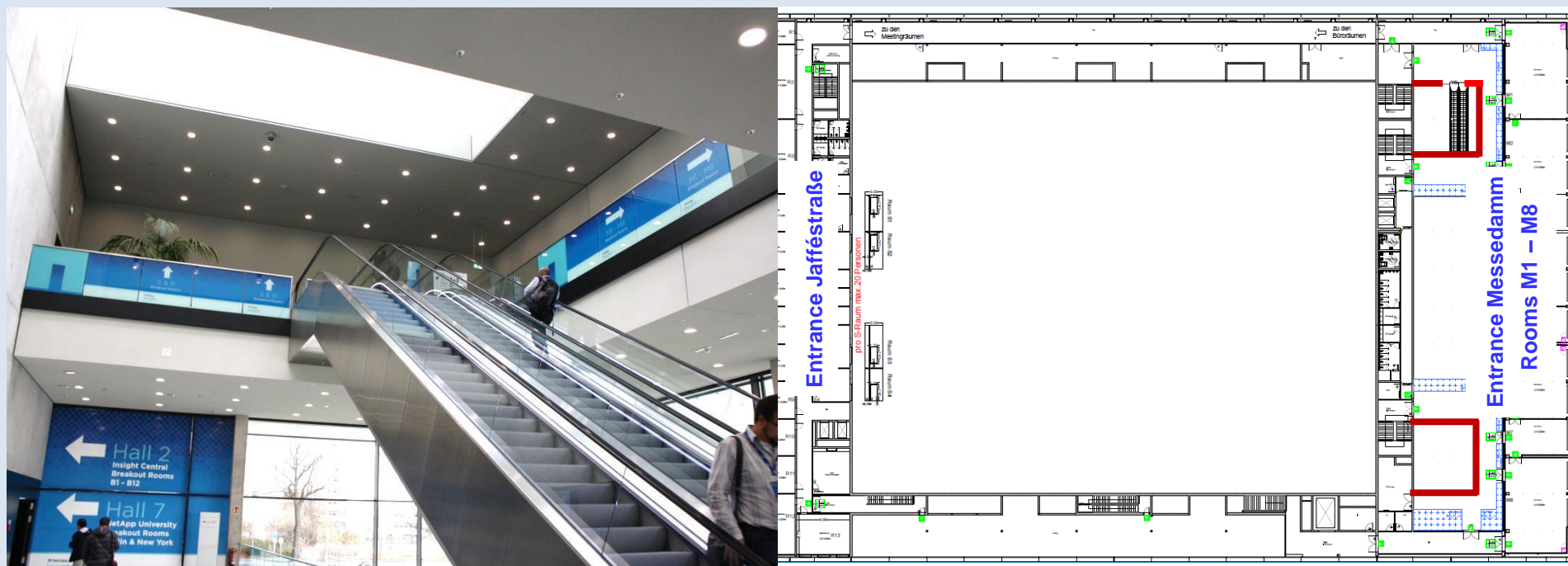

Availability on request

Location/Short Description	Measurements in m (w x h)	Hire Charge	Production and Installation
❖ 3 balustrades of each lateral part can be branded in the east lobby 3 in front of the meeting rooms M1 – M8: see red marks on the right map	approx. 11.80 x 1.00 middle	4.100 Euro	868 Euro
	approx. 11.00 x 1.00 side	3.900 Euro	795 Euro
	approx. 11.00 x 1.00 side	3.900 Euro	795 Euro
	or approx. 7.80 x 1.00 side (escalator)	2.900 Euro	565 Euro

All indicated prices plus Value Added Tax. Subject to change. Subject to confirmation. The indicated prices apply to the period of exhibition. Agency commissions will not be accorded. Prices do not include graphic design/ layout of the advertising material.

# CityCube Berlin All Areas Indoor Advertising Specials

---





# CityCube Berlin All Areas: Indoor Specials

## Pillar Brandings, each 4-sided

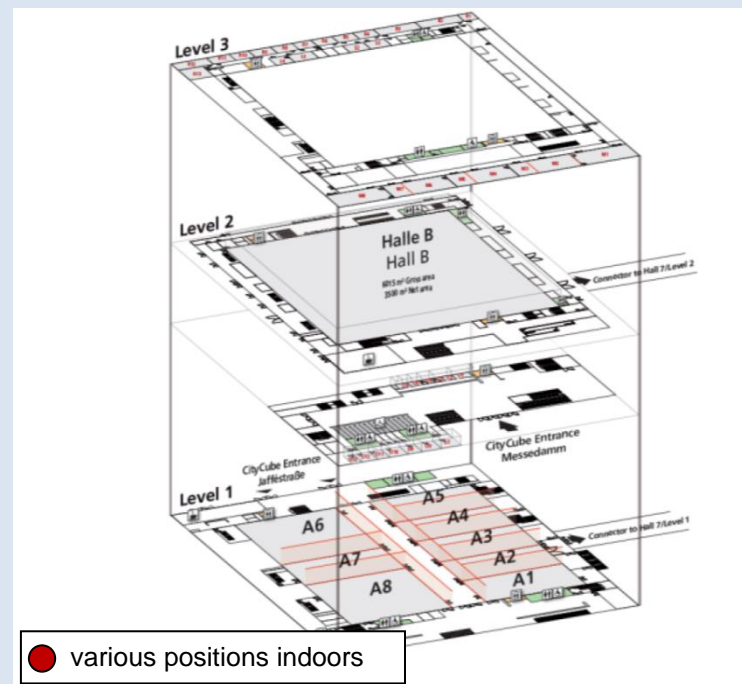
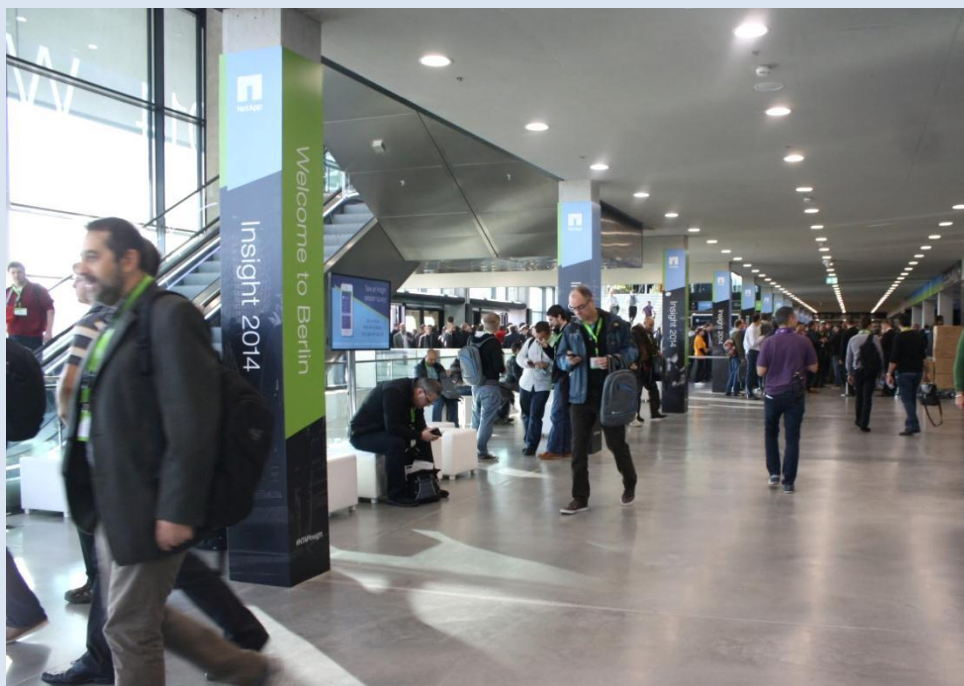

Availability on request

Location/ Short Description	Measurements in m (w x h)	Hire Charge	Production and Installation
❖ wooden encasement of pillars in the entrance lobby as well as on levels 1 and 2	e.g. 0.48 x 3.28 per side (4 sides per pillar)	1.700 Euro per 4-sided pillar branding	675 Euro per 4-sided pillar branding

All indicated prices plus Value Added Tax. Subject to change. Subject to confirmation. The indicated prices apply to the period of exhibition. Agency commissions will not be accorded. Prices do not include graphic design/ layout of the advertising material.

# CityCube Berlin All Areas: Indoor Specials

## Pila Frames

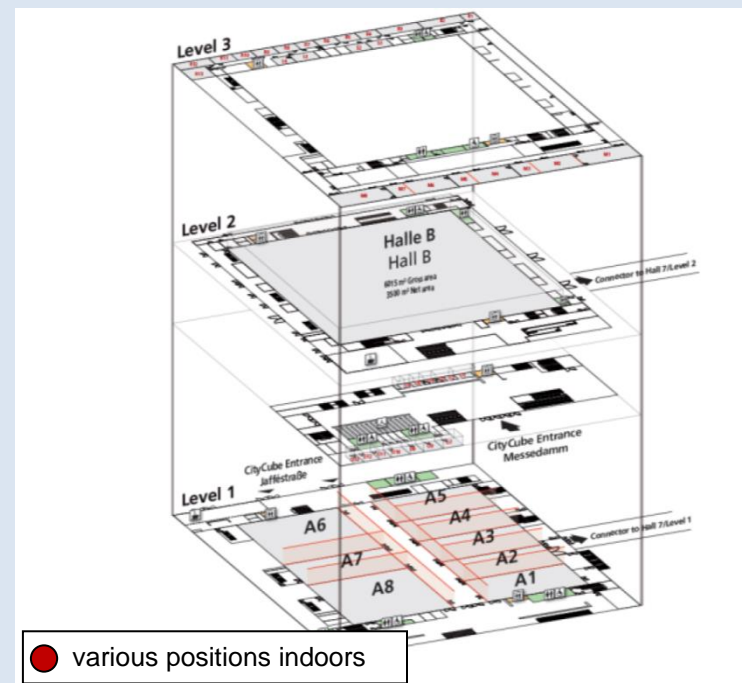

Availability on request

Location/Short Description	Measurements in m (w x h)	Hire Charge	Production and Installation
❖ framed banners in the lobbies on all levels: exact positions by arrangement	e.g. 2.28 x 2.28 per banner Bigger sizes on demand.	1.900 Euro per banner and frame	270 Euro per banner and frame

All indicated prices plus Value Added Tax. Subject to change. Subject to confirmation. The indicated prices apply to the period of exhibition.  
Agency commissions will not be accorded. Prices do not include graphic design/ layout of the advertising material.



# CityCube Berlin All Areas: Indoor Specials

## Ellipse Displays, each 1- or 2-sided

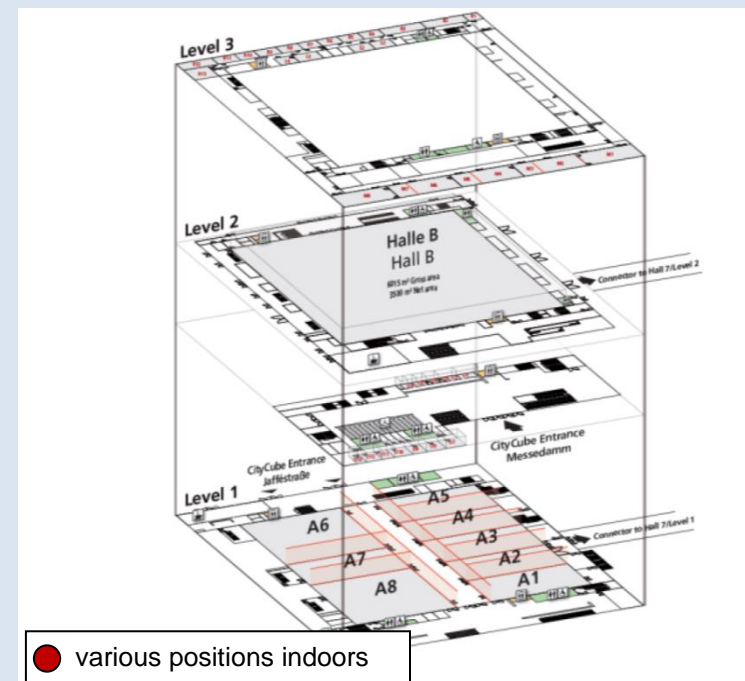
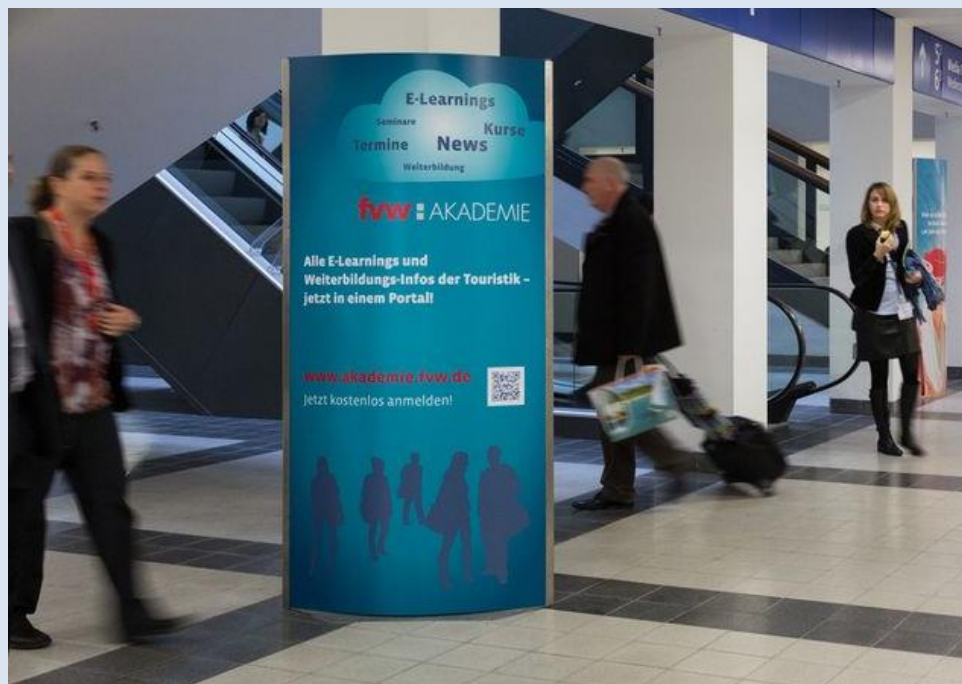

Availability on request

Location/Short Description	Measurements in m (w x h)	Hire Charge	Production and Installation
❖ 1- or 2-sided displays in the lobbies on all levels: exact positions by arrangement	1.00 x 2.00 per display	e.g. 1.100 Euro per 2-sided display	e.g. 315 Euro per 2-sided display

All indicated prices plus Value Added Tax. Subject to change. Subject to confirmation. The indicated prices apply to the period of exhibition. Agency commissions will not be accorded. Prices do not include graphic design/ layout of the advertising material.

## CityCube Berlin All Areas: Indoor Specials

### Paneling Branding around the Elevator Doors

---





# CityCube Berlin All Areas: Indoor Specials

## Paneling Branding around the Elevator Doors

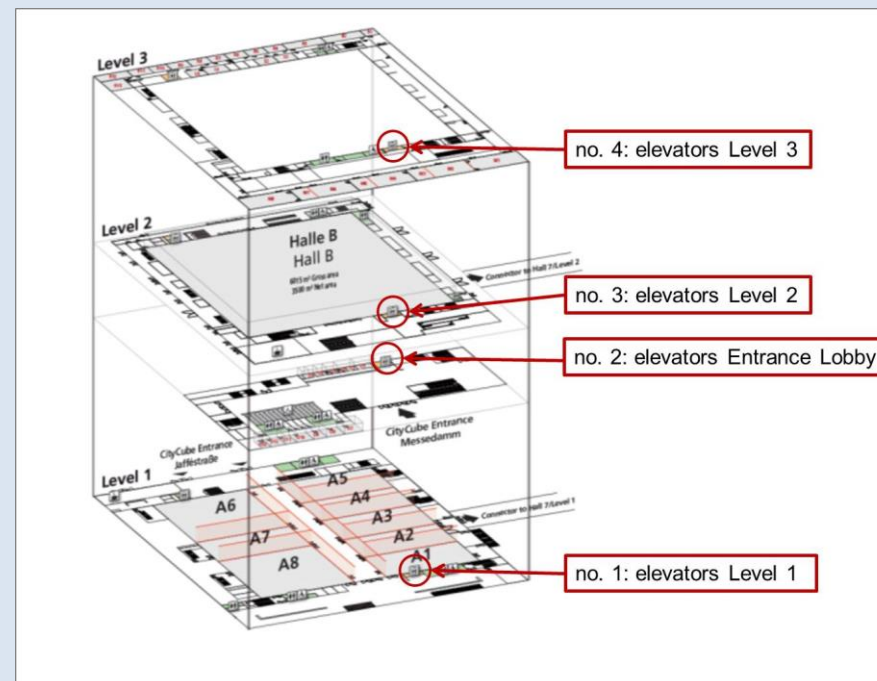

Availability on request

Location/ Short Description	Measurements	Hire Charge	Production and Installation
❖ adhesive foil on the paneling around the doors of elevators: see red marks on the left photo and on the detailed map on the right	approx. 8.38 m <sup>2</sup> per branding (see next page)	2.500 Euro per elevator branding	1.106 Euro per elevator branding

All indicated prices plus Value Added Tax. Subject to change. Subject to confirmation. The indicated prices apply to the period of exhibition. Agency commissions will not be accorded. Prices do not include graphic design/ layout of the advertising material.

# CityCube Berlin All Areas: Indoor Specials

## Paneling Branding around the Elevator Doors

Measurements for the paneling (see black area) around the elevator doors (see grey areas):

**Important note:** these measurements may vary up to +/- 0.5 cm each, so please consider this with regard to your layout.

Please send us printable pdf-files in CMYK mode and make sure that fonts are converted into paths.  
Please send the data files via [www.wetransfer.de](http://www.wetransfer.de) to [senologie-sponsoring@kelcon.de](mailto:senologie-sponsoring@kelcon.de)  
Thank you!

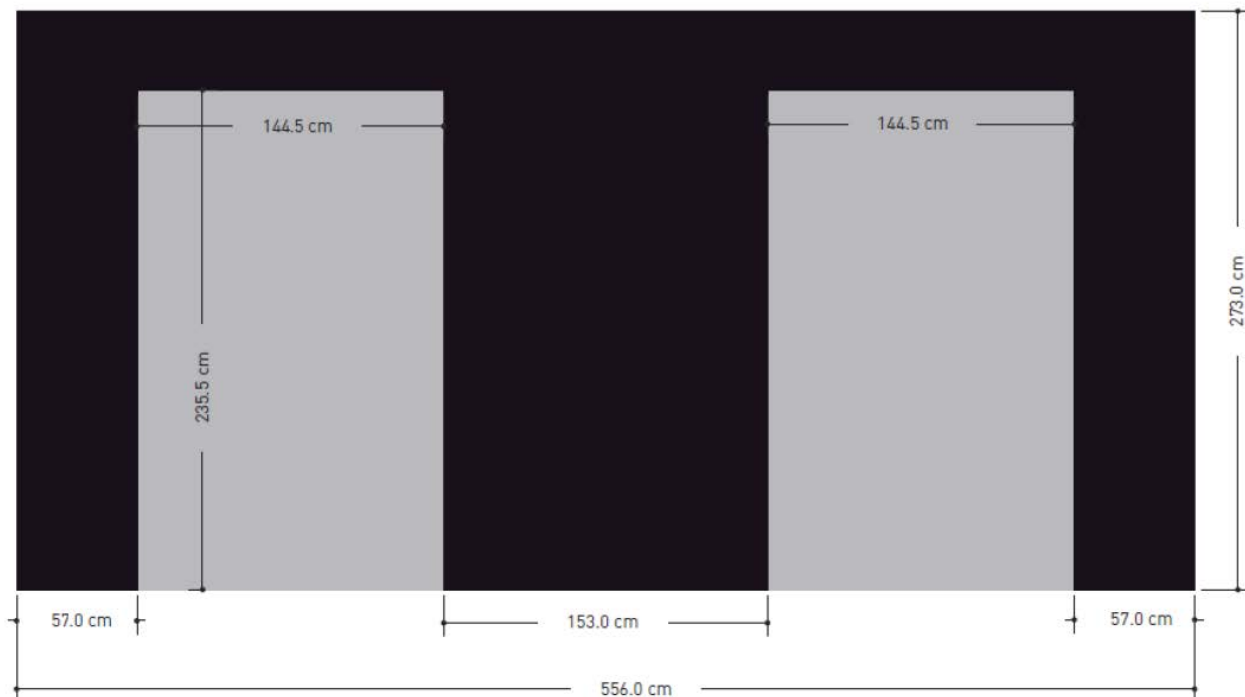

## CityCube Berlin All Areas: Indoor Specials

### Paneling Branding next to the Elevators

---





# CityCube Berlin All Areas: Indoor Specials

## Paneling Branding next to the Elevators

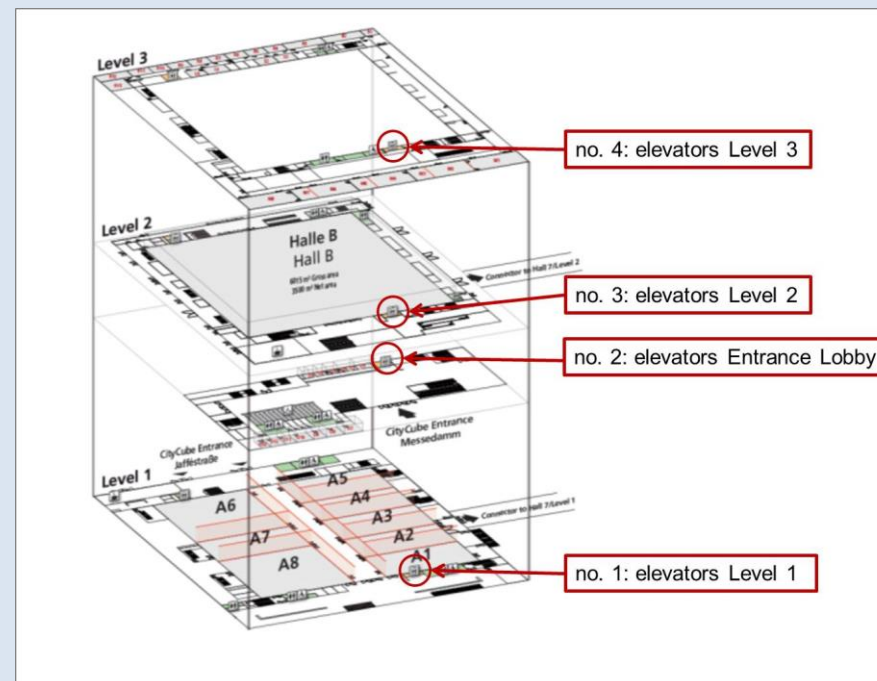
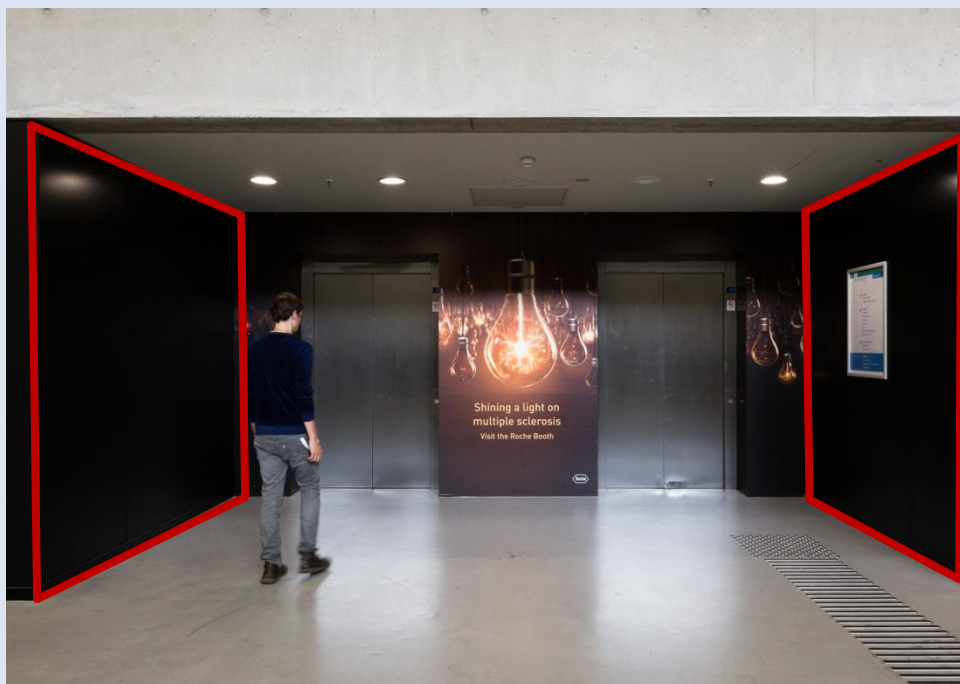

Availability on request

Location/ Short Description	Measurements in m (w x h)	Hire Charge	Production and Installation
❖ adhesive foils on the side walls next to the elevators : see red marks on the left photo and on the detailed map on the right	approx. 2.95 x 2.75 per side wall (see next page)	3.100 Euro for both side walls	1.176 Euro for both side walls

All indicated prices plus Value Added Tax. Subject to change. Subject to confirmation. The indicated prices apply to the period of exhibition. Agency commissions will not be accorded. Prices do not include graphic design/ layout of the advertising material.

## CityCube Berlin All Areas: Indoor Specials

### Mirror Graphics in the Sanitary Facilities

---



# CityCube Berlin All Areas: Indoor Specials

## Mirror Graphics in the Sanitary Facilities

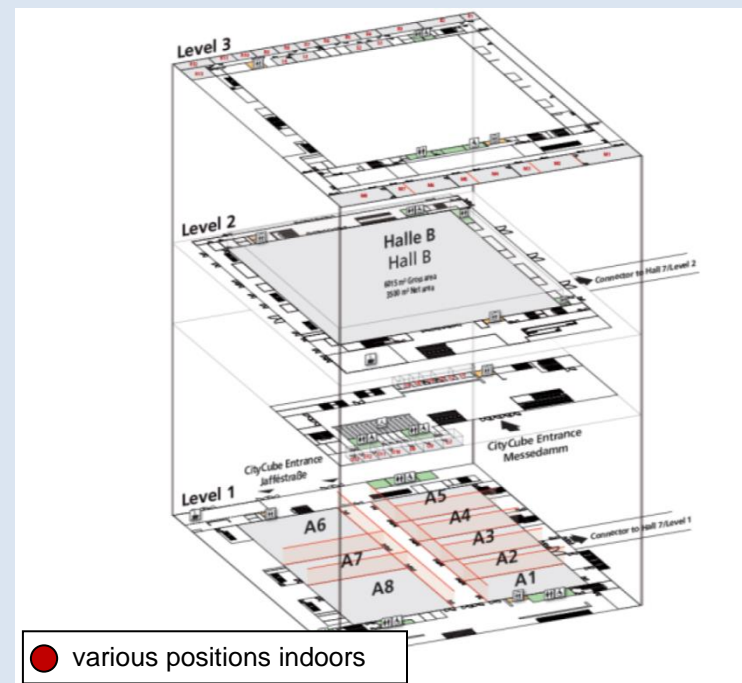

Availability on request

Location/ Short Description	Measurements		Installation
❖ high-quality stickers with your individual design on the mirrors above 52 washbasins in the lavatories	e.g. 0.30 x 0.15 special formats	4.70	52 sticker and

All indicated prices plus Value Added Tax. Subject to change. Subject to confirmation. The indicated prices apply to the period of exhibition. Agency commissions will not be accorded. Prices do not include graphic design/ layout of the advertising material.



## Bestellformular – Werbeflächen vor Ort

Ausstellername

☐ Angabe der firmeninternen Bestellnummer

☐ Firmeninterne Bestellnummer ist notwendig und wird unaufgefordert nachgereicht

☐ Keine firmeninterne Bestellnummer notwendig

### Ihr Ansprechpartner:

Thomas Hausfeld

Tel. +49 (0)30 679 66 88 – 502

Fax +49 (0)30 679 66 88 – 55

@ dggg-sponsoring@kelcon.de

<input type="checkbox"/>	Outdoor Werbeturm, 2,18 x 3,90 m	3.500 €	<input type="checkbox"/>	Banner über Eingang Industrieausstellung, 29 x 2,40 m	7.900 €
<input type="checkbox"/>	Outdoor Werbeturm, 3,18 x 5,90 m	7.300 €	<input type="checkbox"/>	Hängebanner in Foyer M-Ebene/Industrieausstellung, 3 x 6 m	4.700 €
<input type="checkbox"/>	Handlauf Rolltreppen FT1/FT2	3.700 €	<input type="checkbox"/>	Balustradenbeklebung Foyer 3 (M-Räume), 28 x 1 m	6.900 €
<input type="checkbox"/>	Handlauf Rolltreppen FT3/FT4	2.800 €	<input type="checkbox"/>	Balustradenbeklebung Foyer 3 (M-Räume), 11 x 1 m	3.900 €
<input type="checkbox"/>	Handlauf Rolltreppen FT5/FT6	4.200 €	<input type="checkbox"/>	Balustradenbeklebung Foyer 3 (M-Räume), seitlich, 11,80 x 1 m	4.100 €
<input type="checkbox"/>	Balustrade Rolltreppen FT1/FT2	7.400 €	<input type="checkbox"/>	Balustradenbeklebung Foyer 3 (M-Räume), seitlich, 11 x 1 m	3.900 €
<input type="checkbox"/>	Balustrade Rolltreppen FT3/FT4	5.100 €	<input type="checkbox"/>	Balustradenbeklebung Foyer 3 (M-Räume), seitlich, 7,80 x 1 m	2.900 €
<input type="checkbox"/>	Balustrade Rolltreppen FT5/FT6	6.900 €	<input type="checkbox"/>	Säulen Eingangsfoyer, Level 1 und 2, 4-seitig, 0,48 x 3,28 m	1.700 €
<input type="checkbox"/>	Treppenbeklebung Eingangsfoyer, 2,18 x 0,145 m	4.700 €	<input type="checkbox"/>	Pila Rahmen, 2,28 x 2,28 m	1.900 €
<input type="checkbox"/>	Treppenbeklebung Eingangsfoyer, 5,15 x 0,15 m	3.900 €	<input type="checkbox"/>	Display, 1 x 2 m, 2-seitig	1.100 €
<input type="checkbox"/>	Treppenbeklebung Vortrageebene A, 1,80 x 0,145 m	3.900 €	<input type="checkbox"/>	Wandbeklebung um Fahrstuhlzugang, ca. 8,38 m <sup>2</sup>	2.500 €
<input type="checkbox"/>	Treppenbeklebung Vortrageebene A, 4,37 x 0,15 m	5.500 €	<input type="checkbox"/>	Wandbeklebung neben Fahrstuhlzugang, 2,95 x 2,75 m	3.100 €
<input type="checkbox"/>	Banner über Eingang Vortrageebene A, 9,00 x 1,65 m	5.500 €	<input type="checkbox"/>	Spiegelbeklebung in Waschräumen, 0,30 x 0,15 m, 52 St.	VERKAUFT
<input type="checkbox"/>	Balustradenbeklebung Foyer Industrieausstellung, 25 x 1 m	6.100 €	Ihre Bemerkungen: _____ _____		
<input type="checkbox"/>	Balustradenbeklebung Foyer Industrieausstellung, 10 x 1 m	3.300 €			
<input type="checkbox"/>	Balustradenbeklebung Foyer Industrieausstellung, 5 x 1 m	2.100 €			

Alle Preise verstehen sich zzgl. der im Prospekt genannten Produktions- und Installationskosten sowie zzgl. 19 % MwSt..

Detaillierte Mediadata und Informationen zu den einzelnen Werbemöglichkeiten gehen Ihnen nach Buchung zu.

Die Vergabe der Werbeflächen erfolgt nach dem Anmeldedatum, first come-first serve.

### Auszufüllen vom Besteller:

<input type="checkbox"/> Herr	<input type="checkbox"/> Frau
Vorname	
Name	
Telefon	
E-Mail	

Datum

Unterschrift

Firmenstempel

# Contact

**All production and installation rates indicated separately are currently valid and are subject to change without prior notice.  
If applicable, the statutory value added tax at the time of the event will be added to the sum of all costs.  
The rates charged shall be those in effect at the time of the event.  
Additional charges will be incurred if other services are required.  
Modifications and errors excepted.**



**Weitere Informationen zu Werbeflächen vor  
Ort im CityCube Berlin!**

Thomas Hausfeld  
KelCon GmbH

e-mail: [dggg-sponsoring@kelcon.de](mailto:dggg-sponsoring@kelcon.de)  
phone: +49 (0) 30/ 6796688-502  
fax: +49 (0) 30/ 6796688-55